



ASTON FITTINGS & FLANGES MANUFACTURING LTD.



Cert. No. LRQ 0961092

Tel: ++44 (0)121-778 6001
 Fax: ++44 (0)121-778 6002
 sales@astonfittings.com

UNEQUAL UNIONS

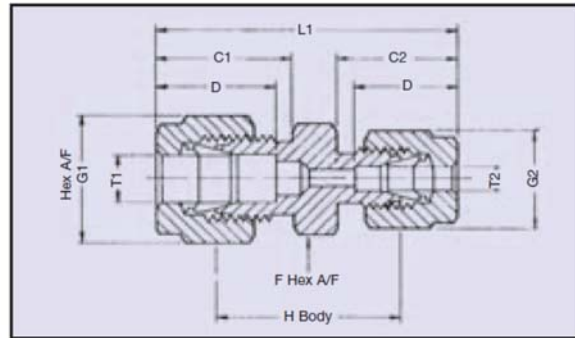

METRIC RANGE (Dimensions in mm)

Part No.	T1 o/d	T2 o/d	L1 Length	C1	C2	F A/F	G1 Nut	G2 Nut	H Body
6-4mRU	6	4	40.48	17.3	15.7	14	14	12	25.4
8-6mRU	8	6	43.26	18.3	17.3	14	17	14	27.1
10-6mRU	10	6	44.45	19.0	17.3	17	19	14	28.5
10-8mRU	10	8	45.24	19.0	18.3	17	19	17	29.4
12-6mRU	12	6	47.63	22.1	17.3	22	22	14	29.3
12-10mRU	12	10	49.21	22.1	19.0	22	22	19	31.0
16-10mRU	16	10	50.01	22.6	19.0	24	27	19	31.8
16-12mRU	16	12	52.39	22.6	22.1	24	27	22	31.8
20-12mRU	20	12	53.98	22.8	22.1	27	30	22	33.4
20-16mRU	20	16	53.98	22.8	22.6	27	32	27	33.4
25-20mRU	25	20	60.32	27.0	22.8	36	41	32	38.1

IMPERIAL RANGE (Dimensions in inches)

Part No.	T1 o/d	T2 o/d	L1 Length	C1	C2	F A/F	G1 Nut	G2 Nut	H Body
3RU2	3/16	1/8	1.42	.62	.60	7/16	1/2	7/16	.89
4RU2	1/4	1/8	1.51	.68	.62	1/2	9/16	7/16	1.00
4RU3	1/4	3/16	1.55	.68	.62	1/2	9/16	1/2	1.00
5RU4	5/16	1/4	1.97	.73	.69	9/16	5/8	9/16	1.40
6RU4	3/8	1/4	1.68	.75	.69	5/8	11/16	9/16	1.12
6RU5	3/8	5/16	1.72	.75	.73	5/8	11/16	5/8	1.16
8RU4	1/2	1/4	1.84	.88	.68	13/16	7/8	9/16	1.16
8RU6	1/2	3/8	1.90	.90	.75	13/16	7/8	11/16	1.22
10RU8	5/8	1/2	2.08	.89	.90	15/16	1	7/8	1.25
12RU8	3/4	1/2	2.10	.91	.90	1-1/16	1-1/8	7/8	1.33
16RU12	1	3/4	2.44	1.06	.91	1-3/8	1-1/2	1-1/8	1.50

- Stainless Steel 316
- Silver Plated Nuts

WE RESERVE THE RIGHT TO CHANGE TOLERANCES AND DIMENSIONS WITHOUT PRIOR NOTICE
 PLEASE CONTACT US IF TOLERANCES AND DIMENSIONS ARE CRITICAL

Units 1-3 Eagle Works 2 Springcroft Road Tyseley Birmingham B11 3EL England

Visit our web page at: <http://www.astonfittings.com>

VALVES - FITTINGS - FLANGES

TUBE - INSTRUMENTATION PACKAGES - SUB CONTRACT MACHINING

Registered in England No 2913370