

DIMENSIONS of 150lb 316 BSP SCREWED FITTINGS

90° Elbow (E)

(Dimensions in mm)

Dimension Letter	1/8	1/4	3/8	1/2	3/4	1	1-1/1	1-1/2	2	2-1/2	3	4
A	18	20	24	28	33	38	44	49	57	68	78	96

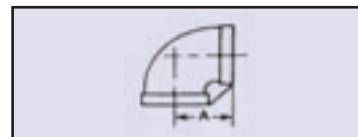

Equal Tee (T)

(Dimensions in mm)

Dimension Letter	1/8	1/4	3/8	1/2	3/4	1	1-1/1	1-1/2	2	2-1/2	3	4
B	18	20	24	28	33	38	44	49	57	68	78	96

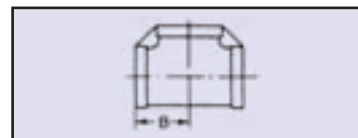

Equal Cross (C)

(Dimensions in mm)

Dimension Letter	1/8	1/4	3/8	1/2	3/4	1	1-1/1	1-1/2	2	2-1/2	3	4
C	18	20	24	28	33	38	44	49	57	68	78	96

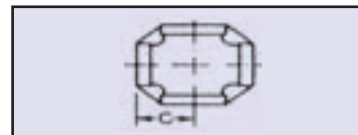

Street Elbow (SE)

(Dimensions in mm)

Dimension Letter	1/8	1/4	3/8	1/2	3/4	1	1-1/1	1-1/2	2	2-1/2	3	4
E	18	20	24	28	33	38	44	49	57	68	78	96
F	25	29	37	41	48	54	61	70	84	96	103	125

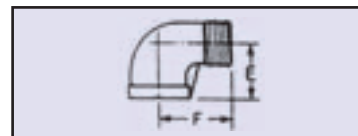

45° Elbow (EA)

(Dimensions in mm)

Dimension Letter	1/8	1/4	3/8	1/2	3/4	1	1-1/1	1-1/2	2	2-1/2	3	4
D	18	19	20	23	25	29	33	37	43	50	56	67



Union F/F Conical (UC)

(Dimensions in mm)

Dimension Letter	1/8	1/4	3/8	1/2	3/4	1	1-1/1	1-1/2	2	2-1/2	3	4
H	25	31	37	42	50	59	69	78	93	112	127	158
G	30.5	34	38	41	43	51.5	54.5	58.5	65.5	83	92	113

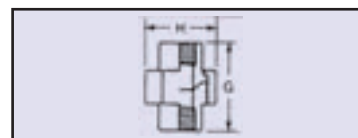

Union M/F Conical (UCM)

(Dimensions in mm)

Dimension Letter	1/8	1/4	3/8	1/2	3/4	1	1-1/1	1-1/2	2	2-1/2	3	4
S	25	31	37	42	50	59	69	78	93	112	127	158
T	40.5	45	52	57	61	71	76	81	90	111	122	150



Hex Nipple (HN)

(Dimensions in mm)

Dimension Letter	1/8	1/4	3/8	1/2	3/4	1	1-1/1	1-1/2	2	2-1/2	3	4
N	12	15	19	23	29	36	45	50	63	78	91	116
M	22	24	28	34	40	46	52	54	60	70	76	92

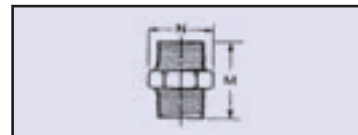

Hex Red Nipple (RHN)

(Dimensions in mm)

Dimension Letter	1/8	1/4	3/8	1/2	3/4	1	1-1/1	1-1/2	2	2-1/2	3	4
N	-	15	19	23	29	36	45	50	63	78	91	116
M	-	34	35	38	42	50	54	59	64	73	81	92

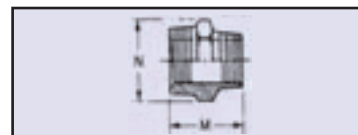

Hex Plug (HP)

(Dimensions in mm)

Dimension Letter	1/8	1/4	3/8	1/2	3/4	1	1-1/1	1-1/2	2	2-1/2	3	4
J	12	15	19	23	29	36	45	50	63	78	91	116
I	13	15	17	20	24	27	31	33	38	43	48	58

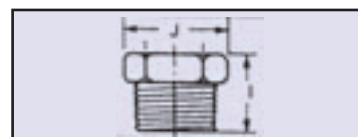

Square Plug (SP)

(Dimensions in mm)

Dimension Letter	1/8	1/4	3/8	1/2	3/4	1	1-1/1	1-1/2	2	2-1/2	3	4
U	6	8	10	14	17	19	23	26	32	41	46	58
V	16	19	22	25	28	31	35	36	41	48	53	62

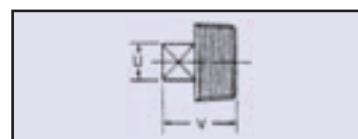

Reducing Bush (RB)

(Dimensions in mm)

Dimension Letter	1/8	1/4	3/8	1/2	3/4	1	1-1/1	1-1/2	2	2-1/2	3	4
L	-	15	19	23	29	36	45	50	62	78	91	116
K	-	15	17	20	24	27	31	33	38	43	48	58

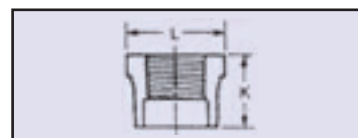

DIMENSIONS of 150lb 316 BSP SCREWED FITTINGS

ROUND CAP (RC)

(Dimensions in mm)

Dimension Letter	1/8	1/4	3/8	1/2	3/4	1	1-1/4	1-1/2	2	2-1/2	3	4
P	16	20	24	29	36	43	52	59	72	88	102	128
O	13	15	17	19	22	24	27	27	32	35	38	45

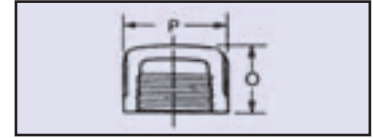

HEX CAP (HC)

(Dimensions in mm)

Dimension Letter	1/8	1/4	3/8	1/2	3/4	1	1-1/4	1-1/2	2	2-1/2	3	4
B	13	17	21	26	32	40	48	55	69	85	99	125
A	13	15	17	19	22	24	27	27	32	35	38	45

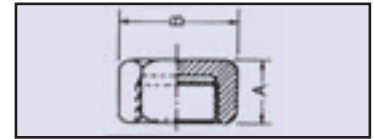

REDUCING SOCKET (RS)

(Dimensions in mm)

Dimension Letter	1/8	1/4	3/8	1/2	3/4	1	1-1/4	1-1/2	2	2-1/2	3	4
K		28	28	35	39	43	49	53	59	67	74	89
L		20	24	29	36	43	52	69	72	89	103	130

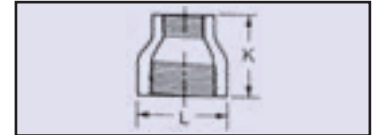

FULL SOCKET (S)

(Dimensions in mm)

Dimension Letter	1/8	1/4	3/8	1/2	3/4	1	1-1/4	1-1/2	2	2-1/2	3	4
Q	17	25	26	27	32	39.5	48.3	54.5	66.3	82	95	122
R	14	19	22	34	36	43	48	48	56	65	71	83

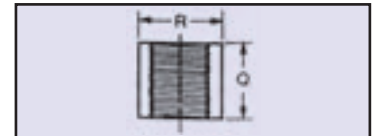

HEX LOCKNUT (LN)

(Dimensions in mm)

Dimension Letter	1/8	1/4	3/8	1/2	3/4	1	1-1/4	1-1/2	2	2-1/2	3	4
C	17	21	26	32	38	46	54	63	77	100	115	145
D	7	8	9	9	10	11	12	13	15	17	18	22

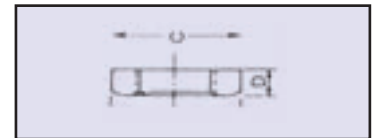

HALF SOCKET (HS)

(Dimensions in mm)

Dimension Letter	1/8	1/4	3/8	1/2	3/4	1	1-1/4	1-1/2	2	2-1/2	3	4
R	14	18.5	21.3	26.4	31.8	39.5	48.3	54.5	66.3	82	95	122
Q	7	11	12	15	16	20	22	22	26	30	33	39

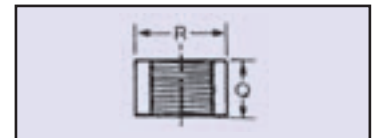

BARREL NIPPLE (BN)

(Dimensions in mm)

Dimension Letter	1/8	1/4	3/8	1/2	3/4	1	1-1/4	1-1/2	2	2-1/2	3	4
L	30	30	40	60	60	60	80	80	100	100	120	120

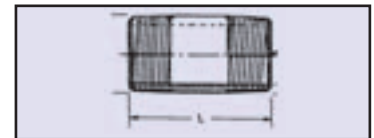

WELD NIPPLE (WN)

(Dimensions in mm)

Dimension Letter	1/8	1/4	3/8	1/2	3/4	1	1-1/4	1-1/2	2	2-1/2	3	4
L	30	30	30	35	40	40	50	50	50	60	70	80



PARALLEL NIPPLE (PN)

(Dimensions in mm)

Dimension Letter	1/8	1/4	3/8	1/2	3/4	1	1-1/4	1-1/2	2	2-1/2	3	4
L	16	18	22	25	30	35	38	38	45	55	60	70



90° MALE BEND (MB)

(Dimensions in mm)

Dimension Letter	1/8	1/4	3/8	1/2	3/4	1	1-1/4	1-1/2	2	2-1/2	3	4
L	50	60	78	80	100	120	140	160	190	240	290	375



HOSE TAILS (HT)

(Dimensions in mm)

Dimension Letter	1/8	1/4	3/8	1/2	3/4	1	1-1/4	1-1/2	2	2-1/2	3	4
O	30	40	45	50	55	70	80	90	100	-	-	-

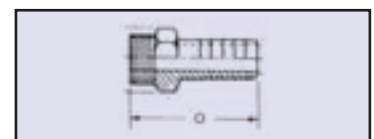

CLOSE TAPER NIPPLE (CTN)

(Dimensions in mm)

Dimension Letter	1/8	1/4	3/8	1/2	3/4	1	1-1/4	1-1/2	2	2-1/2	3	4
B	13	25	25	29	32	38	38	44	44	57	64	76

